

LAMI-FLEX

FLEXIBLE SHEET COUPLINGS

- Suitable for high speed
- High flexibility
- No cinematic errors in transmission
- High torsional rigidity



The LAMI-FLEX couplings are based on the use of some flexible steel or plastic membranes that pivot on the coupling, thus proportioning it a very good flexibility. The characteristics of LAMI-FLEX result in a transmission of great precision movement.

They are suitable for high rotation speeds, such as robots, machinetools, turbines, dynamometers ...

| | TECHNICAL SPECIFICATIONS | | | | | | | | | |
|-----------------|--------------------------|-----------------|------------|------------------------------|-------------|--------------|--------------------------|-------------------------|--------|------------------|
| | Torque | Clamping torque | Max. Speed | Admissible max. misalignment | | | Torsion spring stiffness | Radial spring stiffness | Weight | Inertia |
| | Ncm | Ncm | rpm | Angular degree | Axial mm | Radial mm | Nm/rad | N/mm | gr | gcm ² |
| LFP 2014 | 50 | 60 | 10000 | ±2.5 | ±0.3 | - | 100 | - | 5 | 2.6 |
| LFP 2016 | 50 | 60 | 10000 | ±3 | ±0.4 | ±0.2 | 45 | 125 | 6 | 2.8 |
| LFA 2213 | 20 | 20 | 10000 | ±2 | ±0.3 | ±0.3 | 14 | 3 | 9.5 | 3.2 |
| LFA 2519 | 40 | 65 | 12000 | ±2.5 | ±0.4 | ±0.25 | 22 | 60 | 16 | 13.5 |
| LFA 2525 | 40 | 65 | 12000 | ±2.5 | ±0.4 | ±0.25 | 22 | 60 | 18 | 15 |
| LFA 3019 | 80 | 80 | 12000 | ±3 | ±0.4 | ±0.4 | 150 | 6 | 16 | 19 |
| LFA 3022 | 60 | 80 | 12000 | ±2.5 | ±0.4 | ±0.3 | 30 | 40 | 30 | 35 |
| LFA 3027 | 60 | 80 | 12000 | ±2.5 | ±0.4 | ±0.3 | 30 | 40 | 32 | 37 |
| LFA 3832 | 400 | 60 | 8000 | ±2.5 | ±0.3 | ±0.3 | 250 | 220 | 53 | 82 |
| LFA 3850 | 400 | 60 | 8000 | ±2.5 | ±0.8 | ±0.8 | 250 | 12 | 63 | 106 |
| LFA 4447 | 15 | 350 | 14000 | 2 | ±0.6 | 0.25 | 6400 | 180 | 156 | 470 |

LFP 2014

Ordering code example: LFP 2014 04/04

| d1/d2 | 02 | 04 | 06 |
|-------|----|----|----|
| 02 | X | X | X |
| 04 | | X | X |
| 06 | | | X |

LFP 2016

Ordering code example: LFP 2016 02/04

| d1/d2 | 02 | 04 | 06 |
|-------|----|----|----|
| 02 | X | X | X |
| 04 | | X | X |
| 06 | | | X |

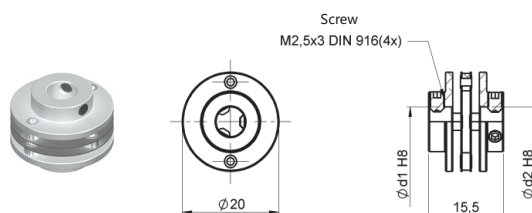
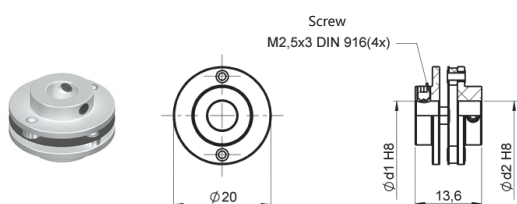

LAMI-FLEX

FLEXIBLE SHEET COUPLINGS

LFA 2213

Ordering code example: LFA 2213 04/04

| d1/d2 | 02 | 03 | 04 |
|-------|----|----|----|
| 02 | X | X | X |
| 03 | | X | X |
| 04 | | | X |

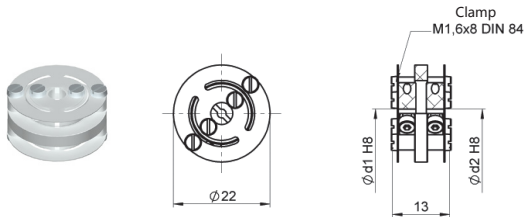

LFA 2525

Ordering code example: LFA 2525 06/06

| d1/d2 | 05 | 06 | 08 | 10 | 12 |
|-------|----|----|----|----|----|
| 05 | X | X | X | X | X |
| 06 | | X | X | X | X |
| 08 | | | X | X | X |
| 10 | | | | X | X |
| 12 | | | | | X |

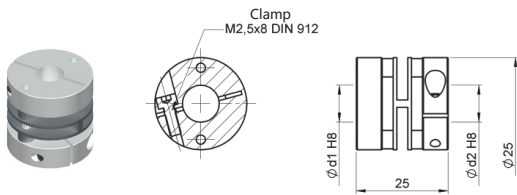

LFA 3022

Ordering code example: LFA 3022 10/10

| d1/d2 | 06 | 08 | 9.52 | 10 | 12 | 14 | 16 |
|-------|----|----|------|----|----|----|----|
| 06 | X | X | X | X | X | X | X |
| 08 | | X | X | X | X | X | X |
| 9.52 | | | X | X | X | X | X |
| 10 | | | | X | X | X | X |
| 12 | | | | | X | X | X |
| 14 | | | | | | X | X |
| 16 | | | | | | | X |

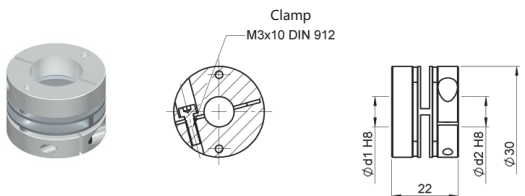

LFA 3832

Ordering code example: LFA 3832 06/06

| d1/d2 | 06 | 08 | 9.52 | 10 | 12 | 14 |
|-------|----|----|------|----|----|----|
| 06 | X | X | X | X | X | X |
| 08 | | X | X | X | X | X |
| 9.52 | | | X | X | X | X |
| 10 | | | | X | X | X |
| 12 | | | | | X | X |
| 14 | | | | | | X |

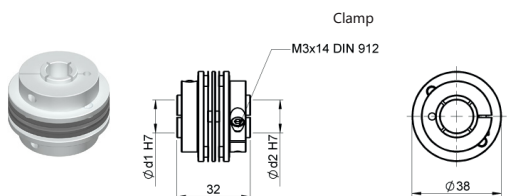

LFA 2519

Ordering code example: LFA 2519 06/06

| d1/d2 | 04 | 05 | 06 | 08 | 10 |
|-------|----|----|----|----|----|
| 04 | X | X | X | X | X |
| 05 | | X | X | X | X |
| 06 | | | X | X | X |
| 08 | | | | X | X |
| 10 | | | | | X |

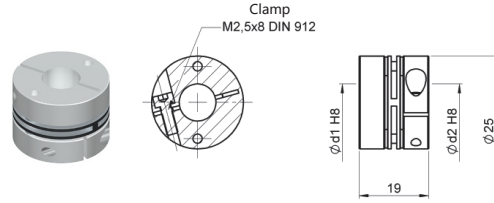

LFA 3019

Ordering code example: LFA 3019 06/08

| d1/d2 | 03 | 04 | 05 | 06 | 6.35 | 08 | 10 |
|-------|----|----|----|----|------|----|----|
| 03 | X | X | X | X | X | X | X |
| 04 | | X | X | X | X | X | X |
| 05 | | | X | X | X | X | X |
| 06 | | | | X | X | X | X |
| 6.35 | | | | | X | X | X |
| 08 | | | | | | X | X |
| 10 | | | | | | | X |

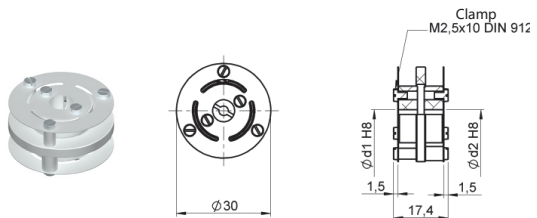

LFA 3027

Ordering code example: LFA 3027 12/12

| d1/d2 | 06 | 08 | 10 | 12 | 14 | 16 |
|-------|----|----|----|----|----|----|
| 06 | X | X | X | X | X | X |
| 08 | | X | X | X | X | X |
| 10 | | | X | X | X | X |
| 12 | | | | X | X | X |
| 14 | | | | | X | X |
| 16 | | | | | | X |

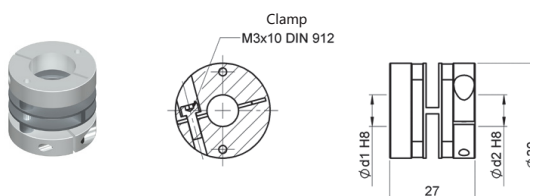

LFA 3850

Ordering code example: LFA 3850 06/06

| d1/d2 | 06 | 08 | 9.52 | 10 | 12 | 14 |
|-------|----|----|------|----|----|----|
| 06 | X | X | X | X | X | X |
| 08 | | X | X | X | X | X |
| 9.52 | | | X | X | X | X |
| 10 | | | | X | X | X |
| 12 | | | | | X | X |
| 14 | | | | | | X |

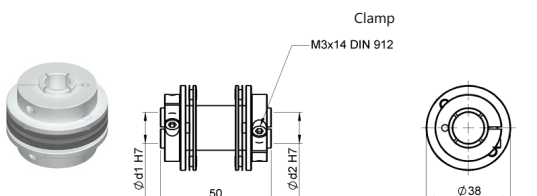

LAMI-FLEX

FLEXIBLE SHEET COUPLINGS

| d1/d2 | 08 | 9.52 | 10 | 11 | 12 | 14 | 15 | 16 | 17 | 18 | 19 | 20 | 22 |
|-------|----|------|----|----|----|----|----|----|----|----|----|----|----|
| 08 | X | X | X | X | X | X | X | X | X | X | X | X | X |
| 9.52 | | X | X | X | X | X | X | X | X | X | X | X | X |
| 10 | | | X | X | X | X | X | X | X | X | X | X | X |
| 11 | | | | X | X | X | X | X | X | X | X | X | X |
| 12 | | | | | X | X | X | X | X | X | X | X | X |
| 14 | | | | | | X | X | X | X | X | X | X | X |
| 15 | | | | | | | X | X | X | X | X | X | X |
| 16 | | | | | | | | X | X | X | X | X | X |
| 17 | | | | | | | | | X | X | X | X | X |
| 18 | | | | | | | | | | X | X | X | X |
| 19 | | | | | | | | | | | X | X | X |
| 20 | | | | | | | | | | | | X | X |
| 22 | | | | | | | | | | | | | X |
| 14 | | | | | | | | | | | | | X |

LFA 4447

Ordering code example:
LFA 4447 11/11

Additional keyway available, upon request

