

SERIE E58 KM SSI

Installation instructions



Installation instructions

Step 1: Release the hollow-shafted magnet support allocated inside the encoder by screwing a grub screw via one of the through holes as shown.

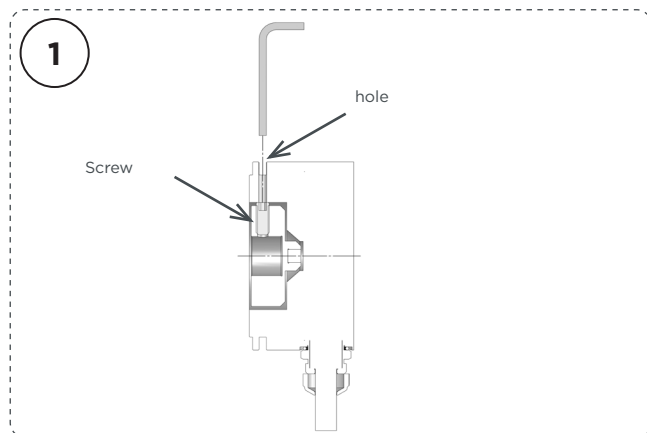

Step 3: Mount encoder using three screws using the three fixing bores of the flange or mount in any angular position by means of three servo clamps.

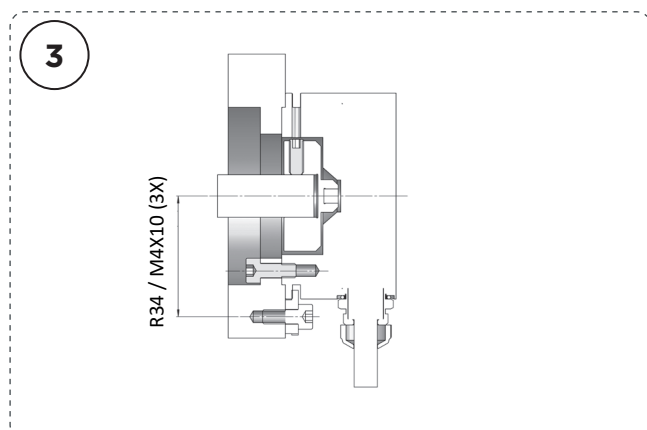

Step 2: Install the magnet support on the motor's shaft while ensuring respecting a suitable gap between the magnet support and the encoder.

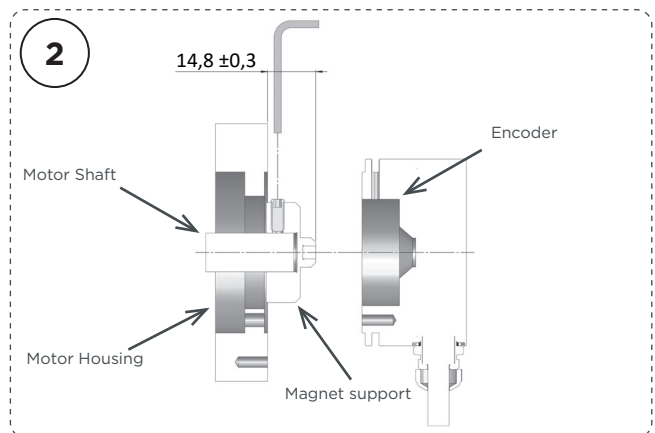

Step 4: With the magnet and the encoder installed, connect the encoder following the provided wire diagram. Turn on the encoder, set the desired zero position by applying a low pulse to the zero wire (blue).

4

CONNECTION

GND	Brown
+UB	White
DT+	Grey
DT-	Pink
CK+	Green
CK-	Yellow
PRESET (*)	Blue
NOT CONNECTED	Red
Shield	Housing

(*) Apply <0,8 VDC pulse (more than 1 ms) to set the encoder to Zero.